

Zoning Amendment

Planning Advisory Committee

237 King St, Pt Lot 10, Con 1, Blyth

September 5, 2017





237 King Street

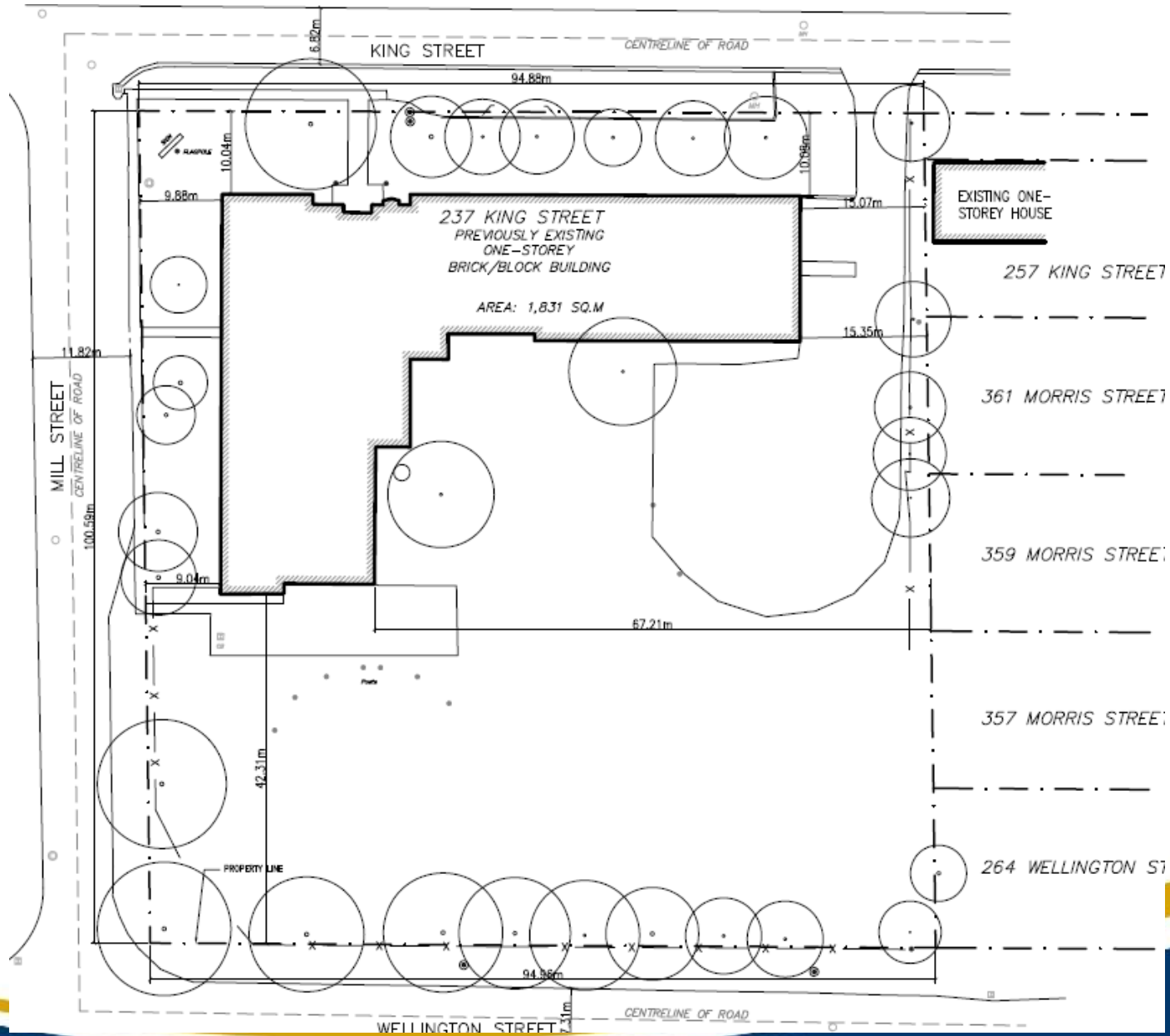





Existing front of subject property



Rendered front of proposed building



Existing rear of subject property



Rendered rear of proposed building



Rendered interior of proposed building

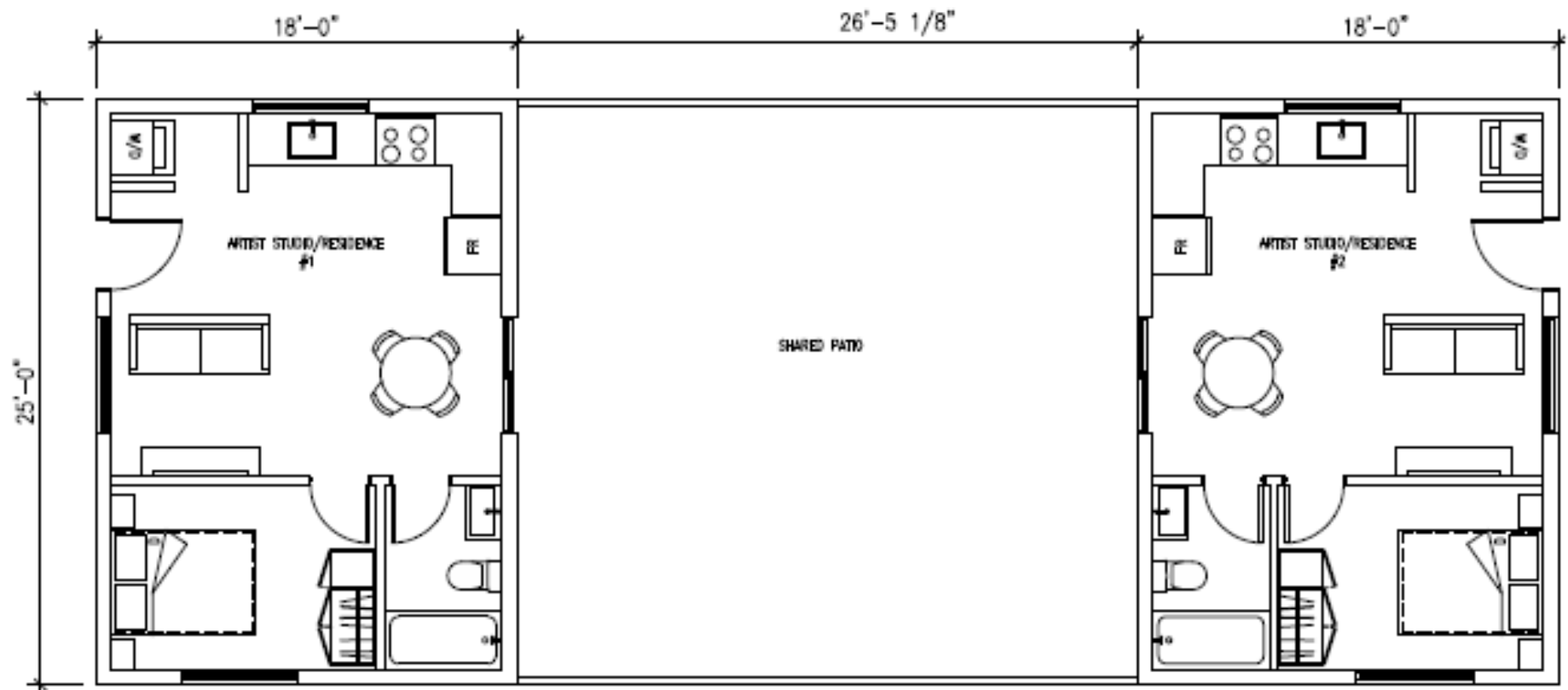

Proposed interior of residential units

Planning Recommendations

- It is recommended that the Zoning Amendment for 237 King Street be approved
- Plus statement from Council to be included for comments received

	A. Effect of Public Comments on Decision of Council	B. Effect of Agency Comments on Decision of Council (e.g. Planning, Public Works, Health Unit)
1. Council agrees with effects of input as contained in the planning report	Council concurs with the planning report regarding the effect of public and agency comments on the decision.	
2. No comments received	No public comments were received on this application so there was no effect on the decision.	No agency comments were received on this application so there was no effect on the decision.
3. Supportive comments received	Public comments were received in support of the application, the effect of which resulted in a decision to approve the application.	Agency comments were received in support of the application, the effect of which resulted in a decision to approve the application.
4. Concerns raised were addressed through conditions to approval or changes to mapping or text amendment	Public comments were received on the issue(s) of _____. The comments were address through (conditions to approval/changes to the mapping or text of the amendment).	Comments were received from agencies on the issues of _____. The comments were addressed through (conditions to approval/changes to the mapping or text of the amendment).
5. Concerns raised did not influence the decision	Public comments were received on the issue(s) of _____. Comments were thoroughly considered but the effect did not influence the decision of Council to (approve/deny) the application.	Comments were received from agencies identifying the issue(s) of _____. Comments were thoroughly considered but the effect did not influence the decision of Council to (approve/deny) the application.
6. Concerns raised did influence the decision	Public comments were received on the issue(s) of _____, the effect of which influenced the decision of Council to (approve/deny) the application.	Agency comments were received on the issue(s) of _____, the effect of which influenced the decision of Council to (approve/deny) the application.
7. Comments received in support and opposition to the application	Options from above 1A/3A/4A/5A/6A	Options from above 1B/3B/4B/5B/6B